



BALLANTYNE

Three bedroom house
Plots 30*, 31, 32*, 33 and 34



BALLANTYNE

Three bedroom house
Plots 30*, 31, 32*, 33 and 34

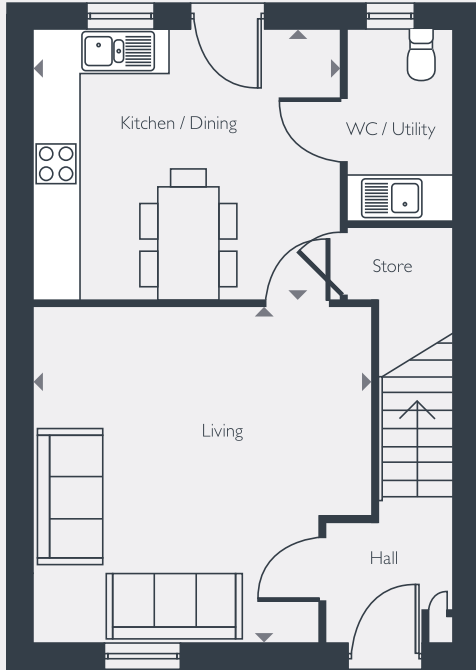

GROUND FLOOR

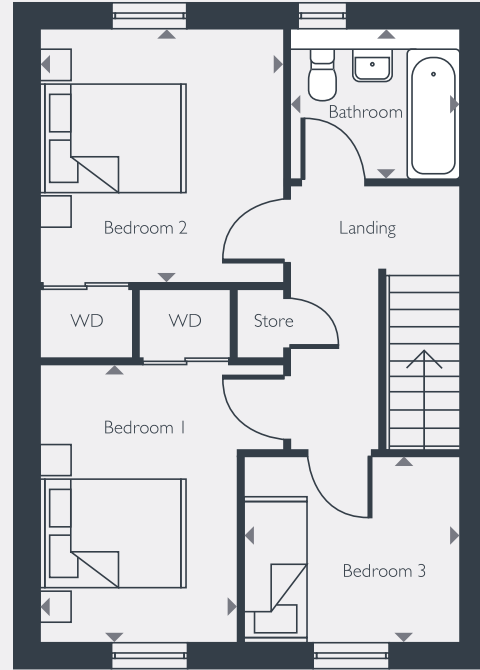

FIRST FLOOR

Internal area

90.3sq.m / 972sq.ft

Layout shown is plots 31, 33 and 34

Plots handed: 30* and 32*

DIMENSIONS	m	ft
Living	4.46m x 4.45m	14'6" x 14'6"
Kitchen / Dining	4.05m x 3.59m	13'3" x 11'8"

	m	ft
Bedroom 1	3.70m x 2.60m	12'1" x 8'5"
Bedroom 2	3.35m x 3.21m	10'10" x 10'5"
Bedroom 3	2.85m x 2.49m	9'4" x 8'2"
Bathroom	2.20m x 1.97m	7'2" x 6'5"



Please note: All layouts and floor plans, configurations, maps and information are intended for guidance only and accuracy of this information cannot be relied upon by prospective purchasers who must make their own enquiries to satisfy themselves by inspection or otherwise as to the correct detail.