



PIRIE

Two bedroom house
Plots 5*, 6, 7*, 8, 10, 11, 12
35*, 36* and 37*



PIRIE

Two bedroom house
Plots 5*, 6, 7*, 8, 10, 11, 12
35*, 36* and 37*

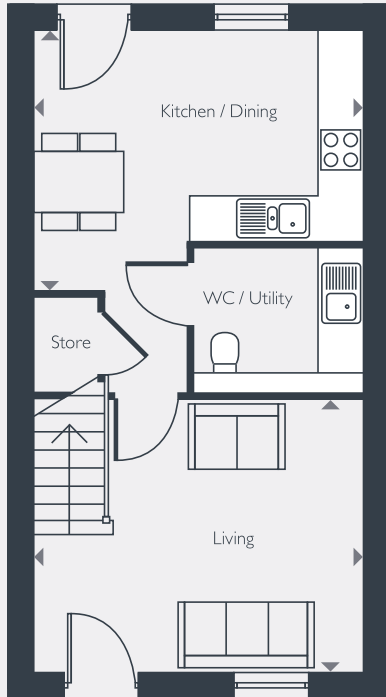

GROUND FLOOR

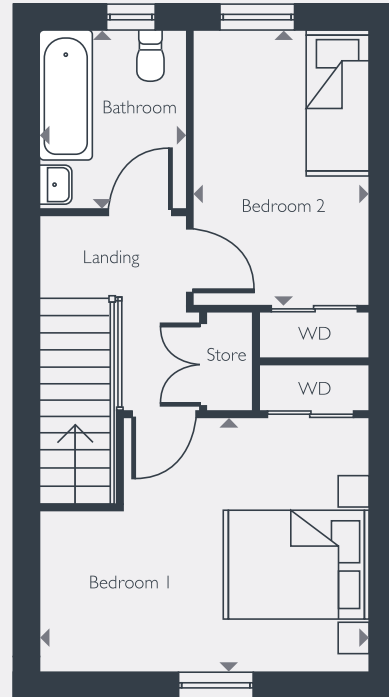

FIRST FLOOR

Internal area

74.5sq.m / 801sq.ft

Layout shown is plots 6, 8, 10, 11 and 12

Plots handed: 5*, 7*, 35*, 36* and 37*

DIMENSIONS	m	ft
Living	4.38m x 3.60m	14'4" x 11'8"
Kitchen / Dining	4.38m x 3.45m	14'4" x 11'3"

	m	ft
Bedroom 1	4.38m x 3.37m	14'4" x 11'1"
Bedroom 2	3.63m x 2.33m	11'9" x 7'6"
Bathroom	2.35m x 1.95m	7'7" x 6'4"



Please note: All layouts and floor plans, configurations, maps and information are intended for guidance only and accuracy of this information cannot be relied upon by prospective purchasers who must make their own enquiries to satisfy themselves by inspection or otherwise as to the correct detail.