

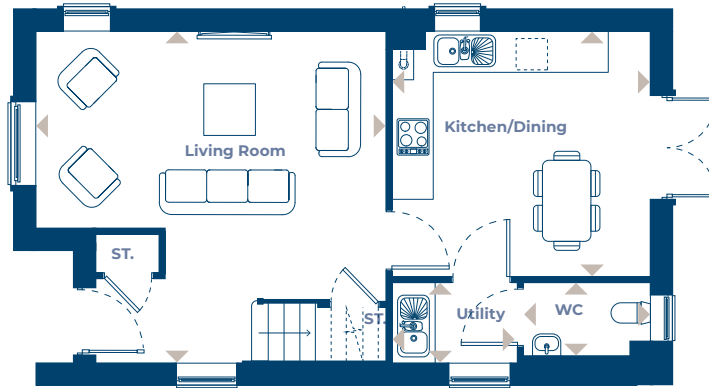

# CASTLE COURT



## PLOTS 16 ~ 3 BEDROOM HOUSE



GROUND FLOOR

Room Dimensions	m	ft
Living Room	5.29 x 4.98	17'4" x 16'4"
Kitchen/Dining	3.85 x 3.70	12'8" x 12'2"
Utility	1.85 x 1.16	6'1" x 3'10"
W.C.	1.88 x 1.07	6'2" x 3'6"

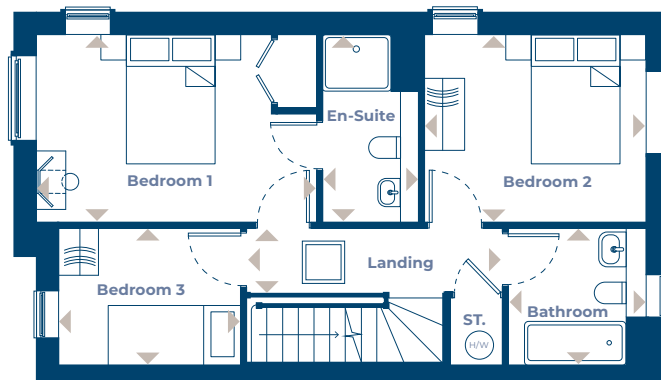

FIRST FLOOR

Room Dimensions	m	ft
Bedroom 1	4.24 x 2.80	13'11" x 9'3"
Bedroom 2	3.35 x 2.80	11'0" x 9'3"
Bedroom 3	2.73 x 2.06	9'0" x 6'9"
Landing	3.90 x 0.98	12'10" x 3'3"
En-Suite	2.80 x 1.42	9'3" x 4'8"
Bathroom	2.06 x 2.04	6'9" x 6'9"

[www.zeroc.co.uk/castlecourt](http://www.zeroc.co.uk/castlecourt)

Please note: All layouts, kitchens, floor plans, configurations, maps and information are intended for guidance only and accuracy of this information cannot be relied upon by prospective purchasers who must make their own enquiries to satisfy themselves by inspection or otherwise as the correct detail.